

# UIPM NATIONAL COMPETITION KIT

by

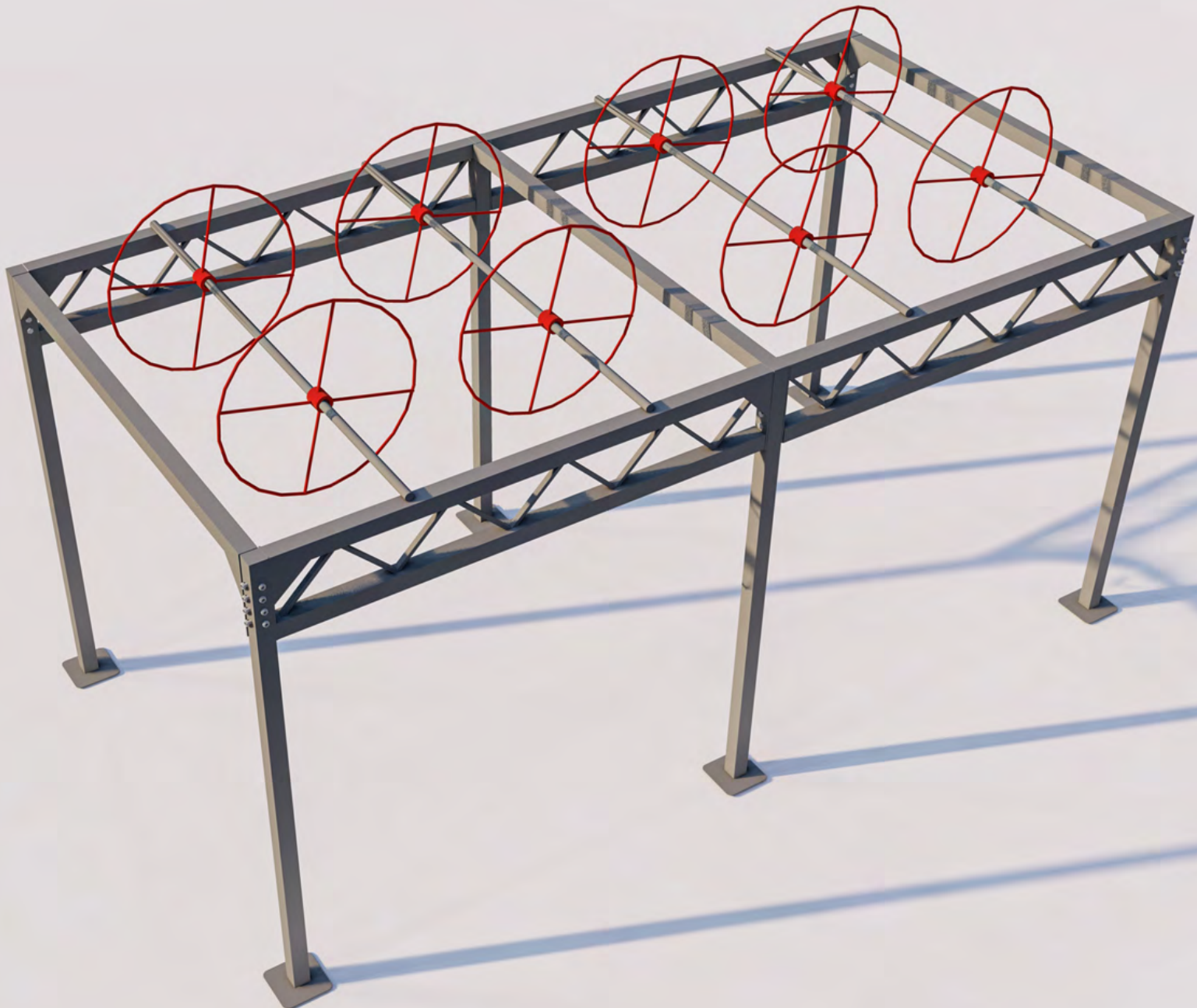

# UIPM NATIONAL COMPETITION KIT

---

The UIPM NATIONAL COMPETITION KIT contains 7 obstacles and boasts a robust steel framework built for durability. Its design prioritizes versatility, allowing seamless adjustment to meet the specific requirements for national and regional competitions.

The use of a modular system with standardized pieces simplifies assembly and enhances adaptability. This approach ensures crucial stability for any structure. The incorporation of 3-meter-long pieces streamlines construction, transportation, and storage processes while maintaining exceptional strength.

The steel bars are hot dip galvanized in accordance with the norm EN ISO 461 and the structure bars have a rectangular section of 80mmx80mmx3mm.

## OBSTACLES

- Steps
- Big Wheel
- Wall 1.5m
- Rings
- Balance Beam
- Wheels
- Monkey bars

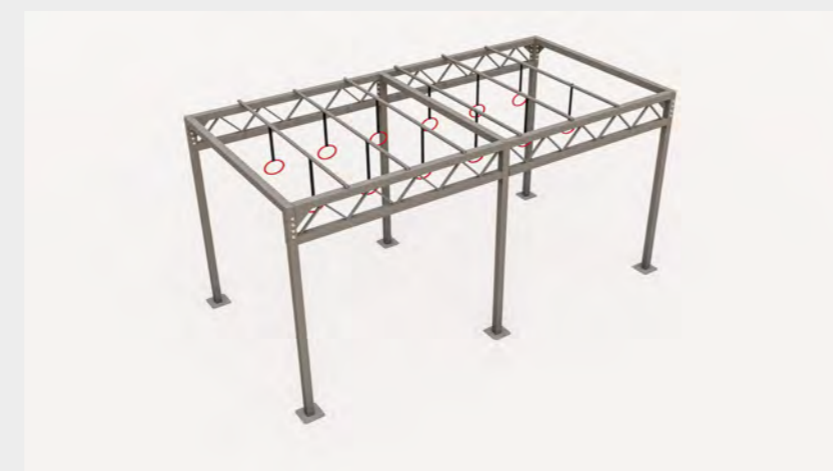
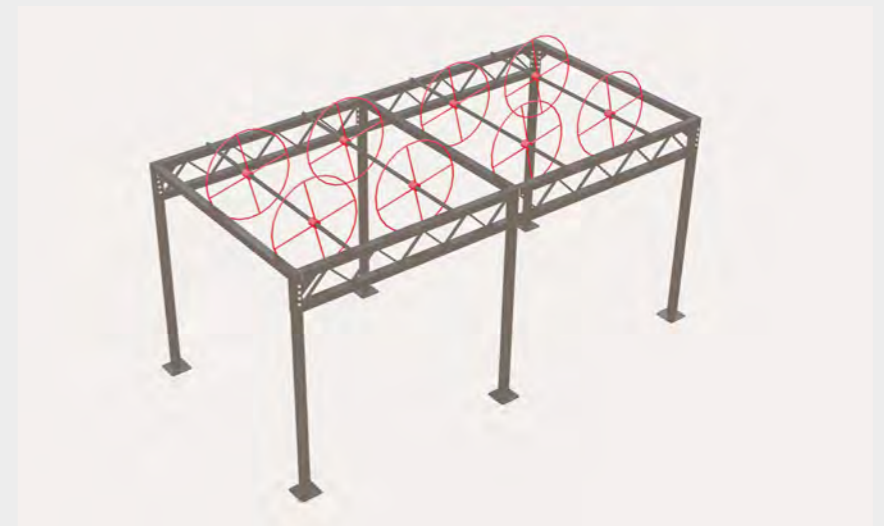
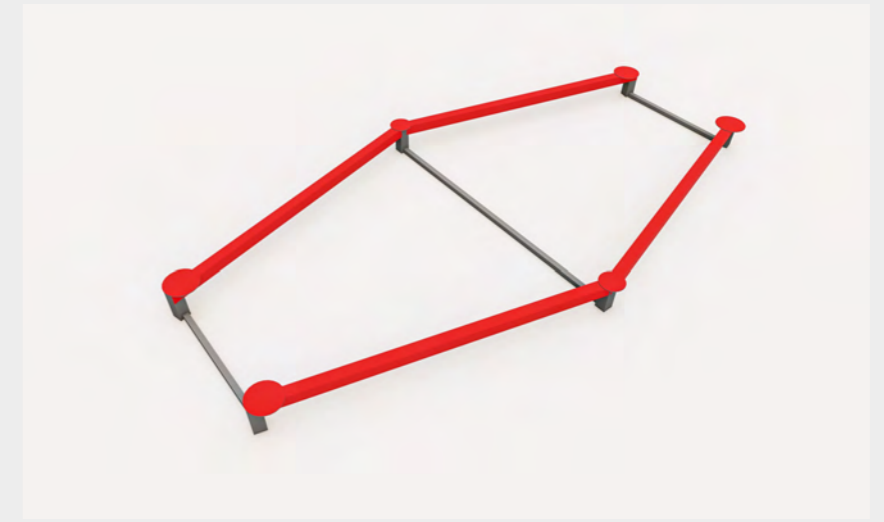
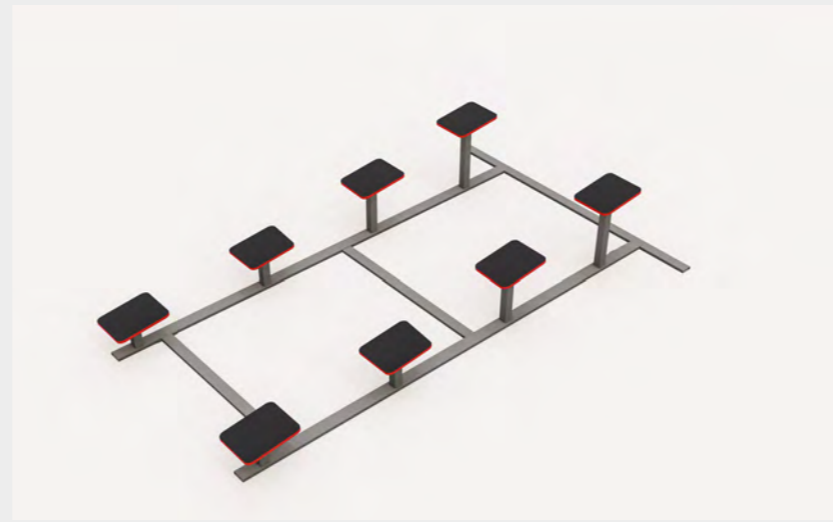

# ADD-ONS & CUSTOMIZATION

---

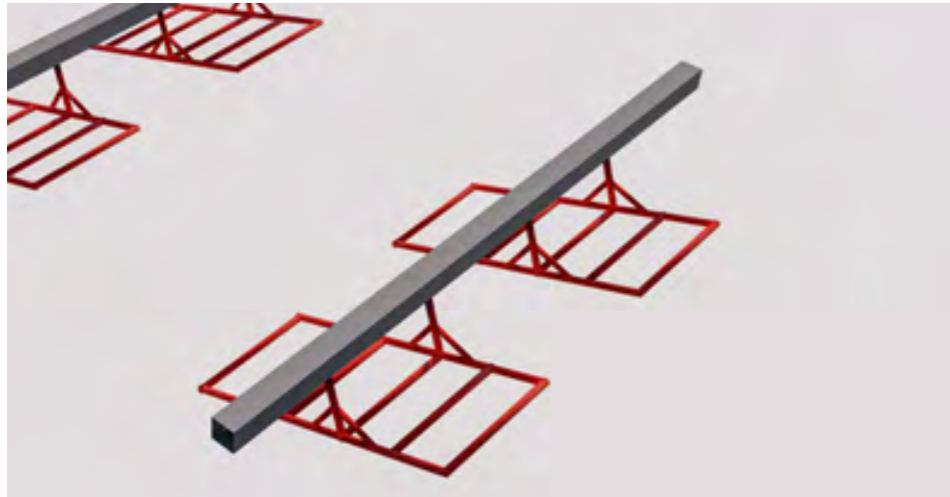

**TILTING LADDER SET**  
(6 TILTING LADDERS )

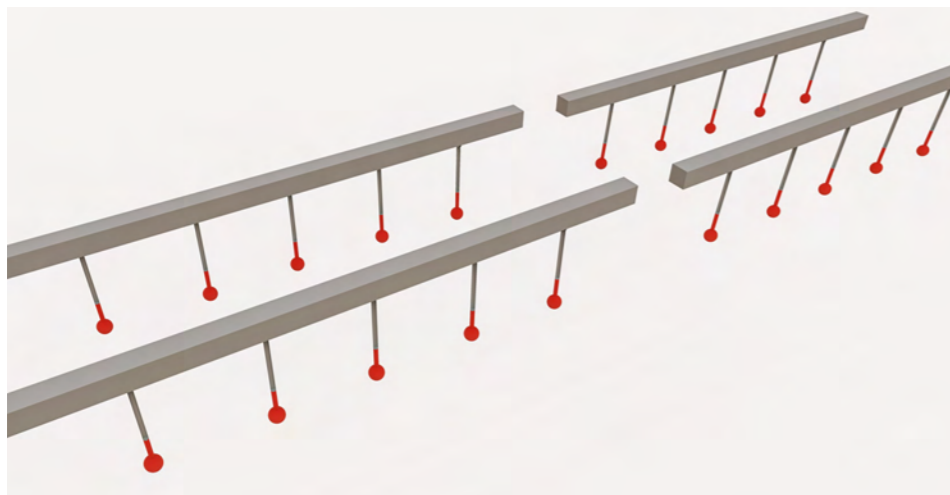

**GLOBES SET**  
(18 GLOBES )



**GIANT STEP SET**  
(10 STEPS )



**FINISH WALL**  
(COMPLETE SET )



**WALL UNDER**



**WALL THROUGH**

## ADD ONS

The obstacles shown on this page are not included in the kit but can be ordered separately as additional components to complement the UIPM National Competition Kit.

# UIPM NATIONAL COMPETITION KIT

---

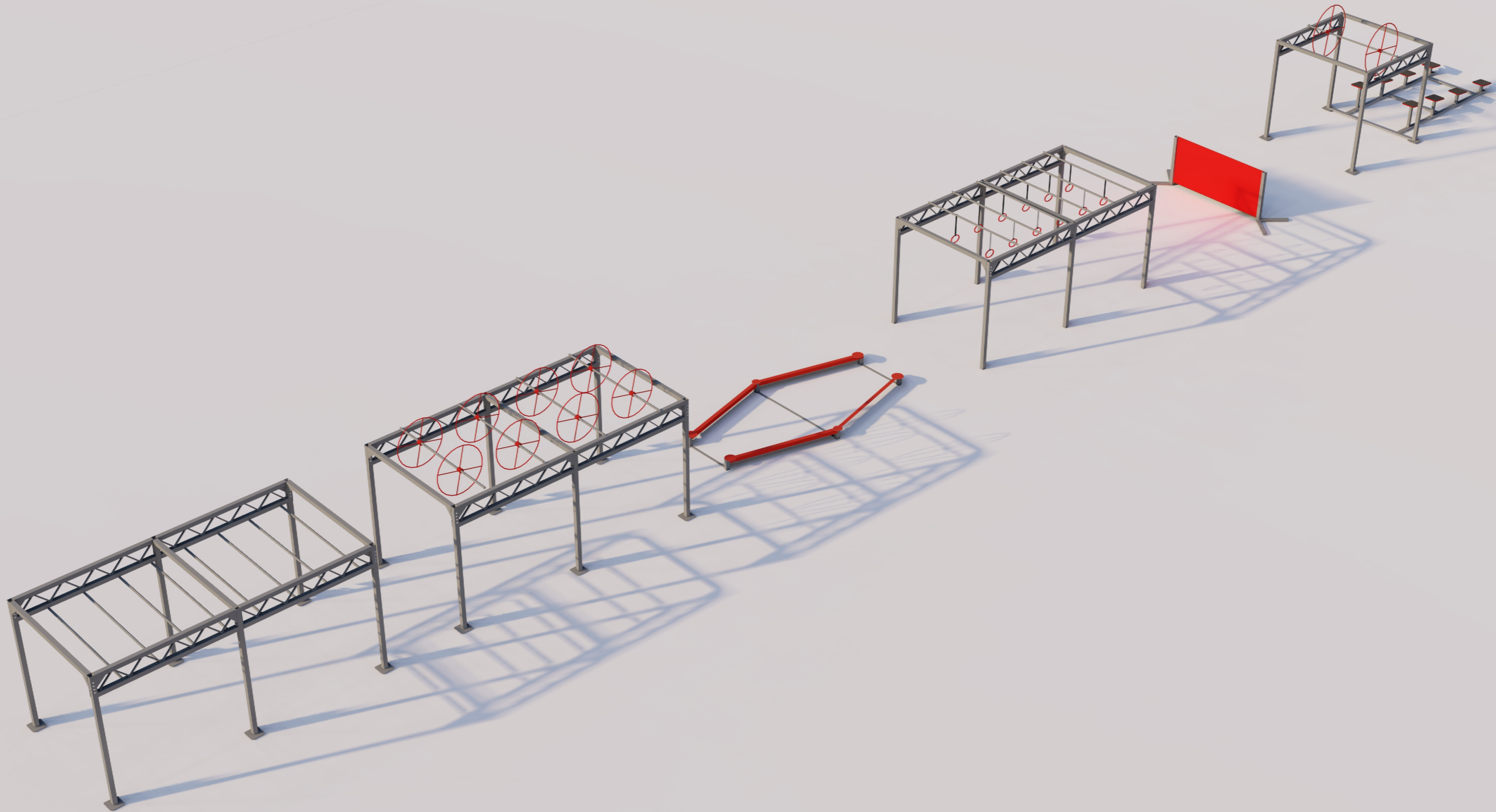

To order a kit and/or any add-ons, or to request any other technical information, please contact [uipm@pentathlon.org](mailto:uipm@pentathlon.org) for assistance.